

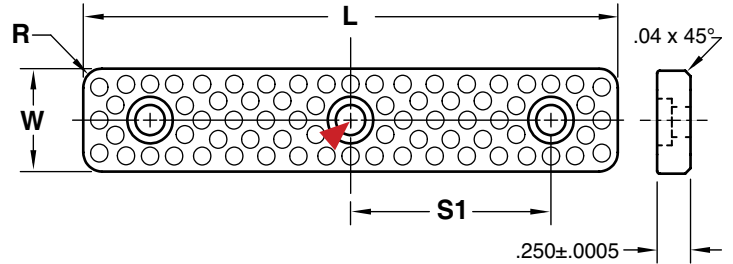

WEAR PLATES

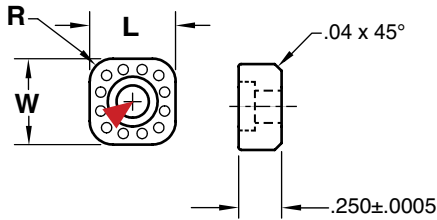

M H-13 **H** Core: 42-48 HRC, Surface: 70 HRC **S** Black Nitride

CATALOG NUMBER	W +.000 -.005	L +.000 -.005	R POCKET RADIUS	LHCS
WP050X050	.500	.500	.125	#8-32 x 3/8

▶ CAD insertion point

M H-13 **H** Core: 42-48 HRC, Surface: 70 HRC **S** Black Nitride

CATALOG NUMBER	W +.000 -.005	L +.000 -.005	S1 ±.01	R POCKET RADIUS	LHCS
WP050X250	.500	2.500	.87	.094	#8-32 x 3/8
WP050X350		3.500	1.37		
WP075X400	.750	4.000	1.50	.125	#10-32 x 3/8
WP075X600		6.000	2.50		

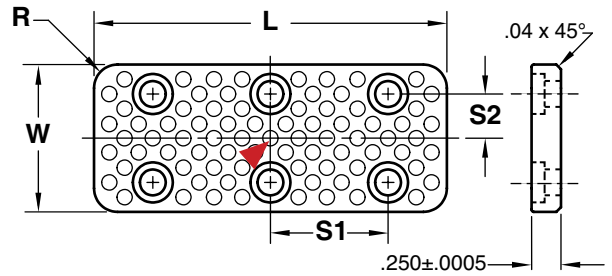
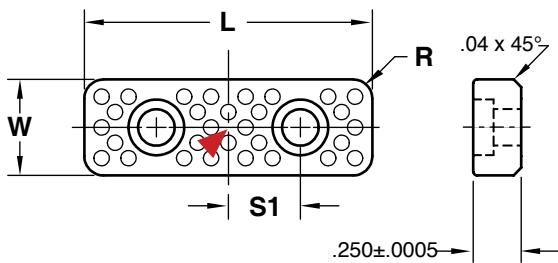

M H-13 **H** Core: 42-48 HRC, Surface: 70 HRC **S** Black Nitride

CATALOG NUMBER	W +.000 -.005	L +.000 -.005	S1 ±.01	R POCKET RADIUS	LHCS
WP050X150	.500	1.500	.37	.094	#8-32 x 3/8
WP075X200	.750	2.000	.50	.125	#10-32 x 3/8

M H-13 **H** Core: 42-48 HRC, Surface: 70 HRC **S** Black Nitride

CATALOG NUMBER	W +.000 -.005	L +.000 -.005	S1 ±.01	S2 ±.01	R POCKET RADIUS	LHCS
WP125X300	1.250	3.000	1.00	.37	.187	#10-32 x 3/8
WP125X500	1.250	5.000	2.00	.37		
WP125X800	1.250	8.000	3.50	.37		
WP200X600	2.000	6.000	2.50	.62		
WP200X800	2.000	8.000	3.50	.62		
WP250X600	2.500	6.000	2.50	.75		
WP300X600	3.000					

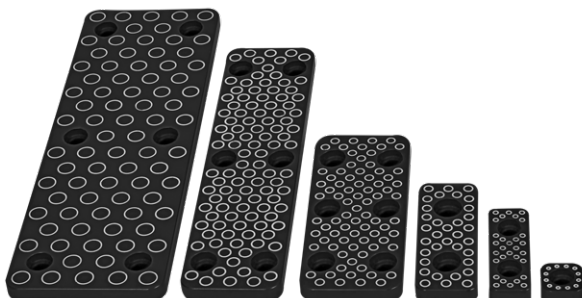

APPLICATION GUIDELINES

- Standardized design is ready to install.
- Wear Plates can be cut as long as the edges have radii.
- Low Head Cap Screws included.