

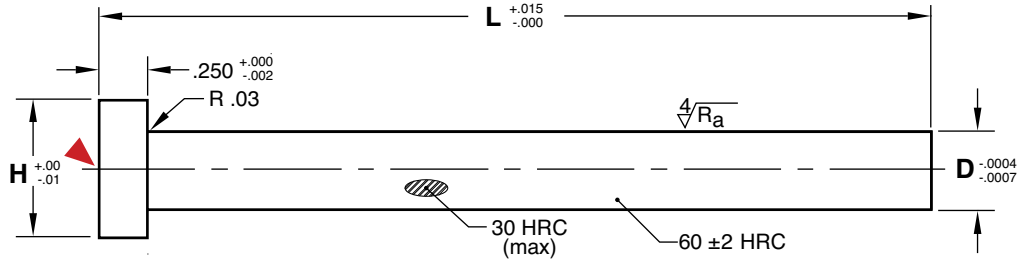

RETURN PINS



M AISI 52100 **H** Core: 30 HRC Max, Surface: 58-62 HRC

▶ CAD insertion point

D=1/2 H=3/4		D=5/8 H=7/8		D=3/4 H=1		D=1 H=1-1/4	
L	CATALOG NUMBER	L	CATALOG NUMBER	L	CATALOG NUMBER	L	CATALOG NUMBER
3-9/16	RP50L3.56	4-1/16	RP62L4.06	4-15/16	RP75L4.93	—	—
4-1/16	RP50L4.06	4-9/16	RP62L4.56	5-7/16	RP75L5.43	—	—
4-9/16	RP50L4.56	5-1/16	RP62L5.06	5-15/16	RP75L5.93	—	—
5-1/16	RP50L5.06	5-9/16	RP62L5.56	6-7/16	RP75L6.43	6	RP100L6
5-9/16	RP50L5.56	6-1/16	RP62L6.06	6-15/16	RP75L6.93	—	—
6-1/16	RP50L6.06	6-9/16	RP62L6.56	7-7/16	RP75L7.43	—	—
6-9/16	RP50L6.56	7-1/16	RP62L7.06	7-15/16	RP75L7.93	—	—
—	—	7-9/16	RP62L7.56	8-7/16	RP75L8.43	—	—
—	—	8-1/16	RP62L8.06	8-15/16	RP75L8.93	—	—
—	—	—	—	9-7/16	RP75L9.43	10	RP100L10
—	—	—	—	—	—	18	RP100L18

ALTERNATIVE CONFIGURATIONS AVAILABLE

- Made-to-order Return Pins can be quoted using the templates at procomps.com.

APPLICATION GUIDELINES

- Return Pins are designed to be drilled and tapped on either end.