

PLATE RETAINERS



The Plate Retainer is designed to hold parting lines or retain plates for sequence functions. The Plate Retainer can also be used in conjunction with other latch components to ensure desired sequencing.

- Incorporates the SRT Slide Retainer for greaseless retention.

Floating A-Plate Application

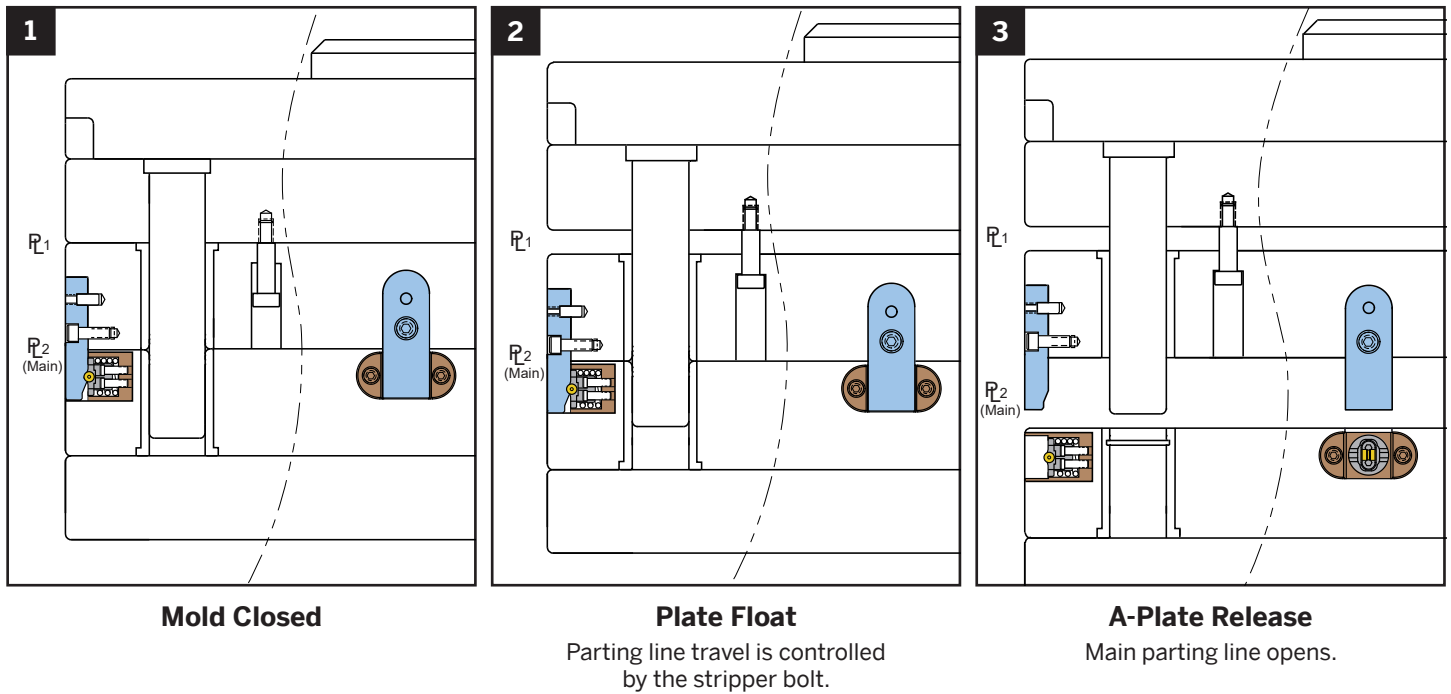

Ejector Plate Applications

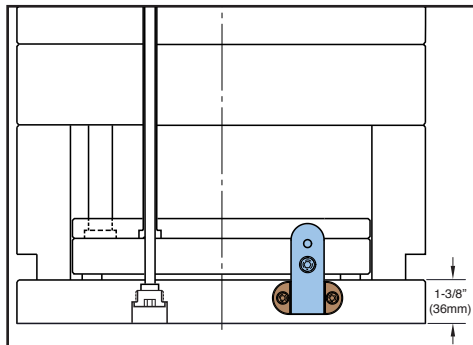

With a 1-3/8" (36mm) bottom clamp plate, the Plate Retainer can be used to retain ejector plates in the molding position.

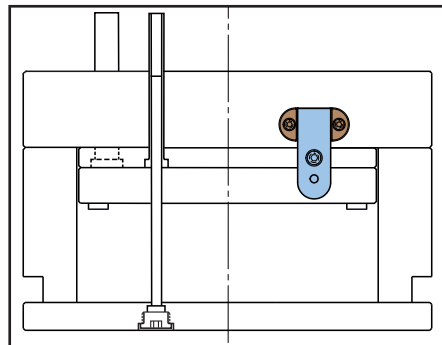

The Plate Retainer can also retain the pin plates in position at the end of a ejector stroke.

Stripper Plate Application

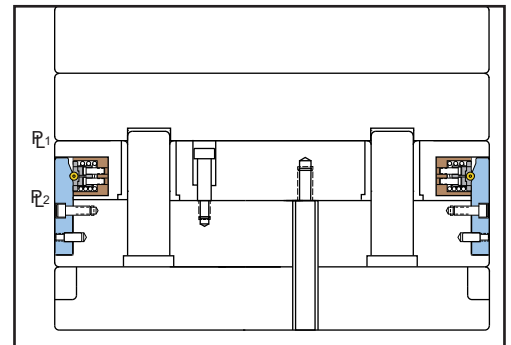

The Plate Retainer can be used to keep stripper plates in molding position during mold open.



PLATE RETAINERS

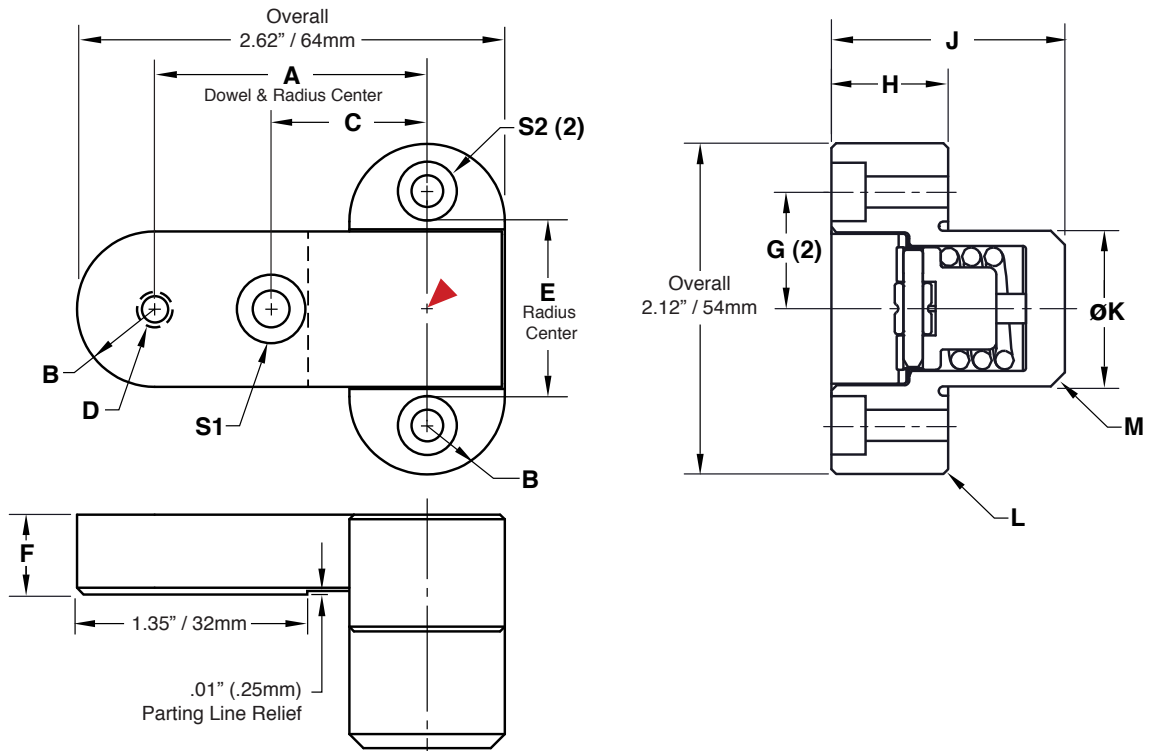

Housing: **M** D-2 **H** 50-54 HRC **S** Black Oxide
 Retainer Bar: **M** 1045 **H** 50-54 HRC **S** Black Oxide

Inch Standard

CAD insertion point

CATALOG NUMBER	A	B Radius	C ± .01	D Dowel	E	F +.000 -.005	G ± .01	H +.000 -.005	J +.000 -.005	K +.000 -.002	L Chamfer	M Chamfer	S1 SHCS	S2 SHCS
PRT80-260	1.625	.500	1.125	1/4 x .50"	1.125	.500	.750	.750	1.500	1.000	.03	.09	1/4-20 x 5/8"	#10-32 x 7/8

Metric Standard

CATALOG NUMBER	A	B Radius	C ± .25	D Dowel	E	F +.00 -.13	G ± .01	H +.00 -.13	J +.00 -.13	K +.00 -.05	L Chamfer	M Chamfer	S1 SHCS	S2 SHCS
PRTM36-64	39	12.5	28	6 x 12	29	12	20	18	38	25	.8	2.5	M6 x 14	M6 x 20

Screws and dowels are included.

Design Guidelines

- The holding force rating for the PRT80-260 is 80 lbs and the PRTM36-64 is 36 kgs.
- It is recommended that four (4) Plate Retainer assemblies are installed, two (2) on each side of the tool, when using to pull plate weights up to 300lbs (120 kg) or approximate plate sizes of 20 x 28 x 1-7/8" (396 x 796 x 46mm) and 18 x 24 x 2-3/8" (346 x 696 x 66).
- Leader Pins must be engaged before the Retainer Bar enters the Plate Retainer housing assembly
- Max operating temperature is 425°F (220°C).