

# EJECTOR PINS

## THROUGH-HARD PINS: STRAIGHT-METRIC DIN STANDARD

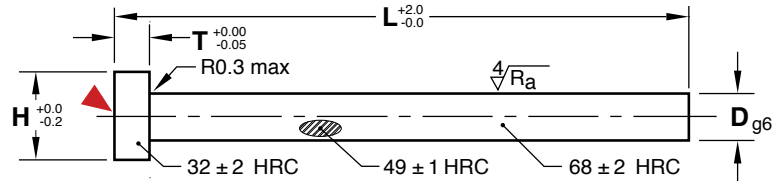

**M** 1.2344 (H-13) **H** Core: 48-50 HRC, Surface: 66-70 HRC

CAD insertion point

D NOMINAL DIAMETER	H	T	L=125MM	L=160MM	L=200MM	L=250MM	L=400MM	L=630MM	L=1000MM
1.2	3	1.5	EPD012L125	EPD012L160	—	—	—	—	—
1.5	3	1.5	EPD015L125	EPD015L160	EPD015L200	EPD015L250	—	—	—
1.6	3	1.5	EPD016L125	—	EPD016L200	EPD016L250	—	—	—
1.7	3	1.5	EPD017L125	—	EPD017L200	EPD017L250	—	—	—
1.8	3	1.5	EPD018L125	—	EPD018L200	EPD018L250	—	—	—
2	4	2	EPD02L125	EPD02L160	EPD02L200	EPD02L250	EPD02L400	—	—
2.2	4	2	EPD022L125	EPD022L160	EPD022L200	EPD022L250	EPD022L400	—	—
2.5	5	2	EPD025L125	EPD025L160	EPD025L200	EPD025L250	EPD025L400	—	—
2.7	5	2	—	EPD027L160	—	EPD027L250	EPD027L400	—	—
3	6	3	EPD03L125	EPD03L160	EPD03L200	EPD03L250	EPD03L400	EPD03L630	—
3.2	6	3	EPD032L125	EPD032L160	EPD032L200	EPD032L250	EPD032L400	—	—
3.5	7	3	EPD035L125	EPD035L160	EPD035L200	EPD035L250	EPD035L400	—	—
3.7	7	3	—	EPD037L160	—	EPD037L250	EPD037L400	—	—
4	8	3	EPD04L125	EPD04L160	EPD04L200	EPD04L250	EPD04L400	EPD04L630	—
4.1	8	3	—	EPD041L160	—	EPD041L250	EPD041L400	—	—
4.2	8	3	EPD042L125	EPD042L160	EPD042L200	EPD042L250	EPD042L400	—	—
4.5	8	3	EPD045L125	EPD045L160	EPD045L200	EPD045L250	EPD045L400	—	—
4.7	8	3	EPD047L125	EPD047L160	EPD047L200	EPD047L250	EPD047L400	—	—
5	10	3	EPD05L125	EPD05L160	EPD05L200	EPD05L250	EPD05L400	EPD05L630	EPD05L1000
5.2	10	3	EPD052L125	EPD052L160	EPD052L200	EPD052L250	EPD052L400	EPD052L630	—
5.5	10	3	EPD055L125	EPD055L160	EPD055L200	EPD055L250	EPD055L400	—	—
6	12	5	EPD06L125	EPD06L160	EPD06L200	EPD06L250	EPD06L400	EPD06L630	EPD06L1000
6.1	12	5	—	EPD061L160	—	EPD061L250	EPD061L400	—	—
6.2	12	5	EPD062L125	EPD062L160	EPD062L200	EPD062L250	EPD062L400	EPD062L630	—
6.5	12	5	EPD065L125	EPD065L160	EPD065L200	EPD065L250	EPD065L400	—	—
7	12	5	EPD07L125	EPD07L160	EPD07L200	EPD07L250	EPD07L400	EPD07L630	EPD07L1000
7.5	12	5	—	EPD075L160	—	EPD075L250	EPD075L400	—	—
8	14	5	EPD08L125	EPD08L160	EPD08L200	EPD08L250	EPD08L400	EPD08L630	EPD08L1000
8.2	14	5	EPD082L125	EPD082L160	EPD082L200	EPD082L250	EPD082L400	EPD082L630	—
8.5	14	5	EPD085L125	EPD085L160	EPD085L200	EPD085L250	EPD085L400	—	—
9	14	5	EPD09L125	EPD09L160	EPD09L200	EPD09L250	EPD09L400	—	—
9.5	14	5	—	EPD095L160	—	EPD095L250	EPD095L400	—	—
10	16	5	EPD10L125	EPD10L160	EPD10L200	EPD10L250	EPD10L400	EPD10L630	EPD10L1000
10.2	16	5	EPD102L125	EPD102L160	EPD102L200	EPD102L250	EPD102L400	—	—
10.5	16	5	EPD105L125	EPD105L160	EPD105L200	EPD105L250	EPD105L400	—	—
11	16	5	EPD11L125	EPD11L160	EPD11L200	EPD11L250	EPD11L400	—	—
12	18	7	EPD12L125	EPD12L160	EPD12L200	EPD12L250	EPD12L400	EPD12L630	EPD12L1000
12.2	18	7	EPD122L125	EPD122L160	EPD122L200	EPD122L250	EPD122L400	—	—
12.5	18	7	EPD125L125	EPD125L160	EPD125L200	EPD125L250	EPD125L400	—	—
14	22	7	EPD14L125	EPD14L160	EPD14L200	EPD14L250	EPD14L400	EPD14L630	—
16	22	7	EPD16L125	EPD16L160	EPD16L200	EPD16L250	EPD16L400	EPD16L630	—
16.2	22	7	—	—	—	EPD162L250	EPD162L400	EPD162L630	—
18	24	7	—	EPD18L160	EPD18L200	EPD18L250	EPD18L400	EPD18L630	—
20	26	8	—	EPD20L160	EPD20L200	EPD20L250	EPD20L400	EPD20L630	EPD20L1000
25	32	10	—	EPD25L160	EPD25L200	EPD25L250	EPD25L400	EPD25L630	EPD25L1000
32	40	10	—	EPD32L160	EPD32L200	EPD32L250	EPD32L400	EPD32L630	EPD32L1000

**ALTERNATIVE CONFIGURATIONS AVAILABLE**

- To order pins with the keys tangent to the diameter, add “-K” to the end of the catalog number. Ex. EPD06L250-K.
- Mold-Ready Ejector Pins can be supplied cut-to-length, keyed, and/or engraved or with Black Nitride. Refer to page A-22 and [procomps.com/mold-ready](http://procomps.com/mold-ready) for more information.