

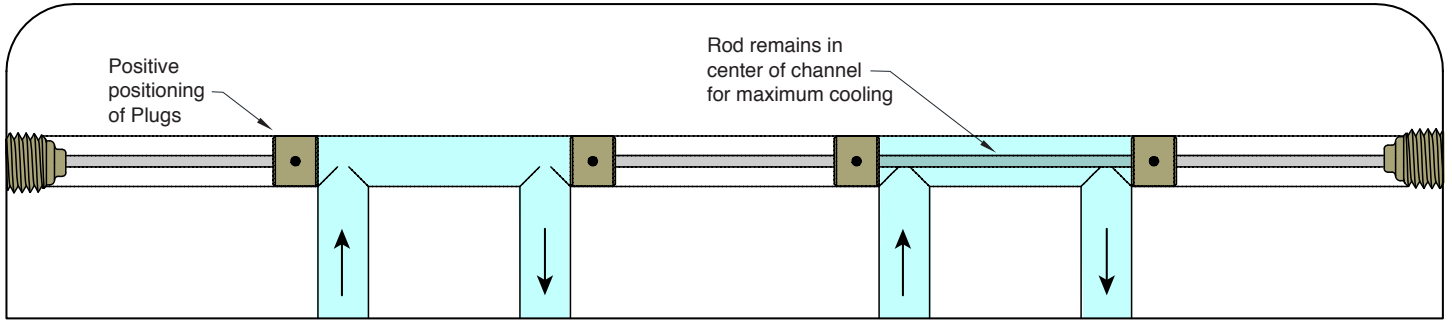

DIVERTING RODS & PLUGS

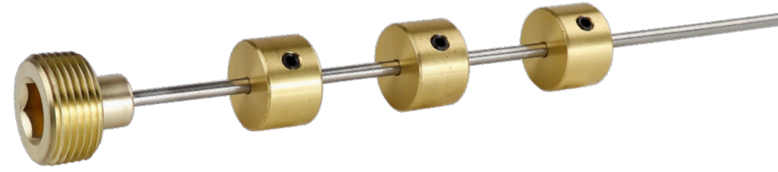

RODS

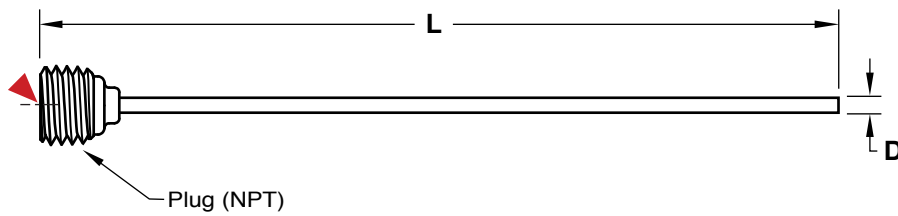

M Brass with Stainless Steel Rod

CATALOG NUMBER	PIPE SIZE NPT	L	D	DIVERTER PLUGS USED
DR125	1/8	12	3/32	D125
DR250	1/4	18	1/8	D250
DR375	3/8	18	1/8	D375
DR500	1/2	24	3/16	D500
DR750	3/4	24	3/16	D750
DR1000	1	36	3/16	D1000

▶ CAD insertion point

ALTERNATIVE CONFIGURATIONS AVAILABLE

- Longer lengths and Diverting Rods cut to length are available. Contact Customer Service for pricing and delivery.

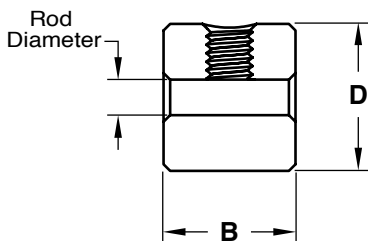

PLUGS



CATALOG NUMBER	FOR PIPE SIZE NPT	FOR ROD DIAMETER	D +.000 -.005	B
D125	1/8	3/32	.340	3/8
D250	1/4	1/8	.432	7/16
D375	3/8	1/8	.557	1/2
D500	1/2	3/16	.682	3/4
D750	3/4	3/16	.932	3/4
D1000	1	3/16	1.115	3/4

Includes locking screw.