

TAPER LOCKS
COUNTERBORED STYLE

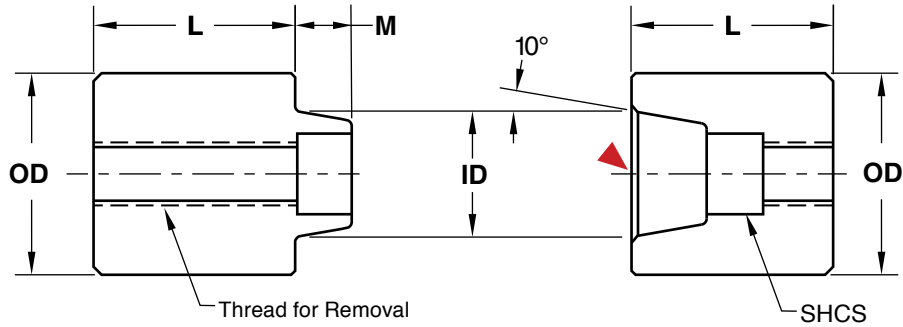

Male: **M** DC53 **H** Core: 58-62 HRC, Surface: 80 HRC **S** Titanium Nitride Coated
 Female: **M** H-13 **H** Core: 42-48 HRC, Surface: 70 HRC **S** Black Nitride

▶ CAD insertion point

CATALOG NUMBER	O.D. +.0000 -.0003	I.D.	M	THREAD SIZE	L +.004 +.008	SHCS	
TLC50	.5000	.375	.200	#10-32	.500	M: #6-32 x 3/4	F: #6-32 x 5/16
TLC75	.7500	.500	.250	1/4-20	.750	M: #10-32 x 1-1/8	F: #10-32 x 1/2
TLC100	1.0000	.625	.343	5/16-18	1.000	M: 1/4-20 x 1-1/2	F: 1/4-20 x 3/4
TLC150	1.5000	1.000	.500	3/8-16	1.250	M: 5/16-18x 2	F: 5/16-18x 7/8
TLC200	2.0000	1.500	.500	3/8-16	1.375	M: 5/16-18x 2	F: 5/16-18 x 1

Screws included.

APPLICATION GUIDELINES

- Designed to be mounted and easily removed from parting line utilizing the internal thread.
- Counterbored Style Taper Locks are sold in sets and the males/ females are designed to be used in assembly and cannot be utilized with the Taper Locks shown on page C-19.

