

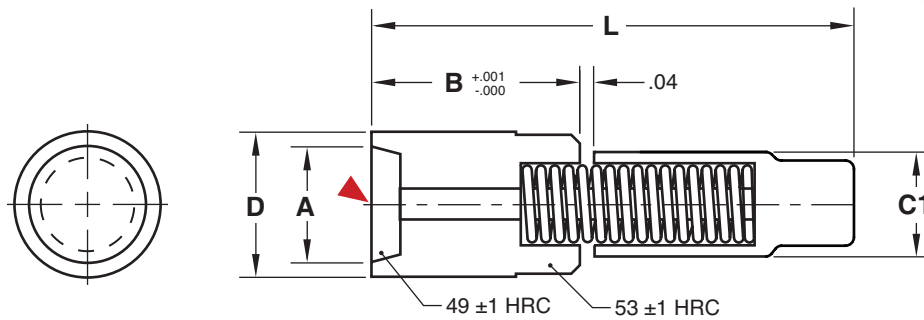

AIR VALVES



M 420 Stainless (1.4034) **H** Body: 52-54 HRC, Plunger: 48-50 HRC (DLC Coated)

CATALOG NUMBER	D		A		B		C1		L	
	MM	Inch	MM	Inch	MM	Inch	MM	Inch	MM	Inch
AV-08	8	.3149 +.0006 +.0002	6.5	.256	11	.433	6	.24	24	1.0
AV-12	12	.4724 +.0007 +.0003	9.7	.382	18	.708	8	.32	34	1.4
AV-18	18	.7086 +.0007 +.0003	14.8	.583	22	.866	12	.47	46	1.8

▶ CAD insertion point

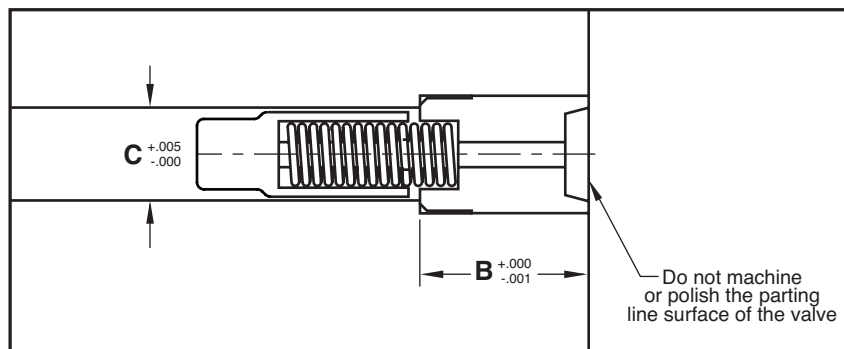

Suggested Machining Diameters

CATALOG NUMBER	C
AV-08	.265
AV-12	.354
AV-18	.551

APPLICATION GUIDELINES

- Assemblies feature corrosion-resistant stainless steel spring.
- Operating Pressure: 29 psi min. / 140 psi max.
- Maximum Mold Temperature: 265 °F (130 °C)
- Press-fit installation required.
- Avoid machining on the front face.
- The activation of the Air Valve should occur at, or slightly before, part ejection.
- The air pressure must end prior to injection, allowing the spring to retract the piston. Failure to do so may allow molten material to enter into the valve, causing damage to the valve or cavity.